

# MODEL 040-0211

PARTS DRAWING      DESSIN DES PIÈCES      ESQUEMA DE LAS PIEZAS

**PUMP SC23**

**PUMP SPECIFICATIONS**  
 WEIGHT - 222 LBS  
 CAPACITY - 50 OZ.  
 MAX RPM - 800  
 OIL GRADE - 10W30

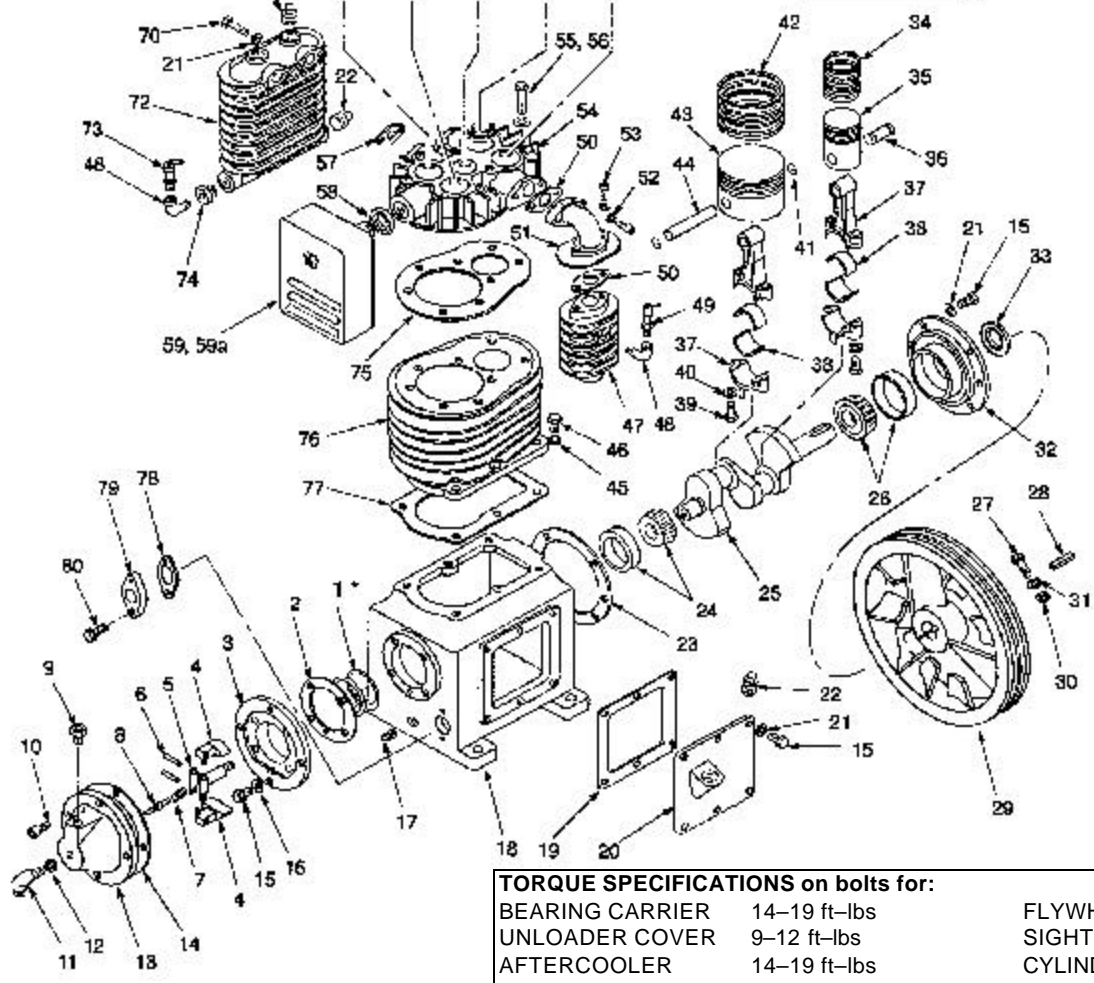
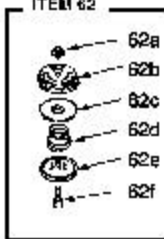
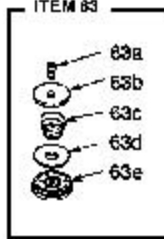
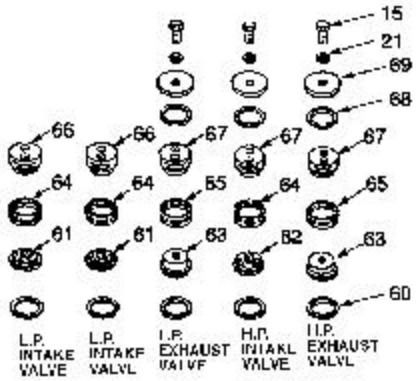
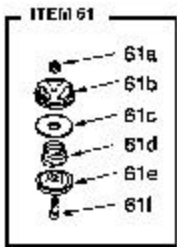

**TORQUE SPECIFICATIONS on bolts for:**

BEARING CARRIER	14-19 ft-lbs	FLYWHEEL	47-57 ft-lbs
UNLOADER COVER	9-12 ft-lbs	SIGHT GLASS	14-19 ft-lbs
AFTERCOOLER	14-19 ft-lbs	CYLINDER	19-27 ft-lbs
INTERCOOLER	14-19 ft-lbs	ROD	34-37 ft-lbs
VALVE RETAINERS	65-70 ft-lbs	HEAD	32-37 ft-lbs
VALVE COVER	14-19 ft-lbs	VALVE	9-12 ft-lbs

\* End Play Specifications - .002 - .004

# MODEL 040-0211

## PARTS LIST      LISTE DE PIÈCES      LISTA DE LAS PIEZAS

**PUMP SC23**

Item Art <u>Art</u>	Part No N° / P <u>Núm / P</u>	Qty Qté <u>Cant</u>	<u>Description</u>	<u>Description</u>	<u>Descripción</u>
1	046-0175 046-0176 046-0177	AR	Shim, bearing adj, .005 thick ..... Shim, bearing adj, .010 thick Shim, bearing adj, .020 thick	Cale .....	Calzo
2	046-0227	1	Gasket, adapter plate .....	Joint .....	Empaquetadura
3	077-0070	1	Plate, adapter, centrif. unloader...	Plaque .....	Placa
4	096-0009	2	Weight.....	Poids .....	Peso
5	114-0112	1	Holder, weight .....	Manche .....	Soporte
6	107-0015	2	Pin .....	Goupille.....	Pasador
7	055-0051	1	Spring.....	Ressort .....	Resorte
8	078-0011	1	Plunger.....	Piston.....	Embolo
9	056-0018	1	Breather, crankcase.....	Reniflard .....	Respiradero
10	059-0156	4	Bolt, M6 x 20 mm lg .....	Boulon.....	Perno
11	031-0057	1	Valve, air, w/valve core .....	Soupape .....	Válvula
12	058-0084	1	Nut, brass, M10.....	Écrou .....	Tuerca
13	077-0071	1	Housing, centrifugal unloader .....	Corps .....	Compartimiento
14	046-0171	1	Gasket.....	Joint .....	Empaquetadura
15	059-0166	21	Bolt, M8 x 20 mm lg .....	Boulon.....	Perno
16	060-0070	4	Washer, lock, 8 mm .....	Rondelle.....	Arandela
17	062-0004	1	Plug, oil drain .....	Bouchon.....	Tapón
18	049-0027	1	Crankcase.....	Carter .....	Cárter
19	046-0169	1	Gasket, side cover.....	Joint .....	Empaquetadura
20	077-0069	1	Cover, side .....	Couvercle.....	Tapa
21	060-0061	19	Washer, copper.52" O.D. x 32" I.D.	Rondelle.....	Arandela
22	062-0006	4	Plug, pipe, 3/4" NPT.....	Bouchon.....	Tapón
23	046-0168	1	Gasket, front cover.....	Joint .....	Empaquetadura
24	051-0054	1	Bearing set, rear .....	Jeu de roulements .....	Conjunto de cojinete
25	053-0051	1	Crankshaft.....	Vilebrequin .....	Cigüeñal
26	051-0053	1	Bearing set, front.....	Jeu de roulements .....	Conjunto de cojinet
27**	059-0163	1	Bolt, M16 x 80mm long .....	Boulon.....	Perno
28**	146-0015	1	Key, flywheel .....	Cle .....	Chaveta
29**	044-0037	1	Flywheel, 16 7/8" O.D. ....	Volant-moteur .....	Volante
30**	058-0086	1	Nut, M16 .....	Écrou .....	Tuerca
31**	060-0069	1	Washer, lock, 16mm .....	Rondelle.....	Arandela
32	045-0044	1	Bearing carrier, front.....	Support, roulement.....	Portador, cojinete
33	046-0179	1	Seal, shaft .....	Joint .....	Sello
34	054-0178	1	Ring set, high pressure .....	Jeu de segment.....	Juego de anillos
35	048-0081	1	Piston, high pressure .....	Piston.....	Pistón
36	052-0028	1	Pin, wrist, high pressure .....	Goupille.....	Pasador
37	047-0054	2	Rod, connecting.....	Tige .....	Varilla
38	051-0055	2 pr.	Insert, bearing .....	Pièce rapportée .....	Inserto
39	059-0154	4	Bolt, rod, M10 x 45 mm lg.....	Boulon.....	Perno
40	060-0072	4	Washer, lock 10 mm .....	Rondelle.....	Arandela
41	054-0119	2	Retaining ring.....	Anneau de retenue .....	Anillo retenedor
42	054-0179	1	Ring set, low pressure .....	Jeu de segment.....	Juego de anillos
43	048-0054	1	Piston, low pressure.....	Piston.....	Pistón
44	052-0027	1	Pin, wrist, low pressure .....	Goupille.....	Pasador
45	060-0063	6	Washer, copper, .66 O.D. x .41 I.D.	Rondelle.....	Arandela
46	059-0159	6	Bolt, cylinder M10 x 30 mm lg.....	Boulon.....	Perno
47	082-0014	1	Aftercooler.....	Refroidisseur supplémentaire	Postrefrigerador
48	064-0022	2	Elbow, 90° street, 1/4".....	Coude .....	Codo
49	136-0047	1	Valve, pressure relief, 225 PSI ....	Soupape .....	Válvula

# MODEL 040-0211

## PARTS LIST \_\_\_\_\_ LISTE DE PIÈCES \_\_\_\_\_ LISTA DE LAS PIEZAS

**PUMP SC23**

Item Art <u>Art</u>	Part No Nº / P <u>Núm / P</u>	Qty Qté <u>Cant</u>	<u>Description</u>	<u>Description</u>	<u>Descripción</u>
50	046-0172	2	Gasket, manifold, aftercooler .....	Joint .....	Empaquetadura
51	083-0009	1	Elbow, manifold, aftercooler.....	Coude .....	Codo
52	060-0070	4	Washer, lock, 8 mm .....	Rondelle.....	Arandela
53	059-0158	4	Bolt, manifold, M8 x 25 mm lg.....	Boulon.....	Perno
54	042-0055	1	Head, cylinder .....	Tête.....	Cabeza
55	059-0167	8	Bolt, head, M12 x 70 mm lg .....	Boulon.....	Perno
56	060-0105	8	Washer, M12.....	Rondelle.....	Arandela
57	046-0173	2	Gasket, intercooler .....	Joint .....	Empaquetadura
58	058-0087	1	Nut, conduit, 1".....	Écrou .....	Tuerca
59	019-0097	1	Filter, cannister assy .....	Filtere .....	Filtro
			includes item 59a		
59a	019-0023	1	Element, filter replacement .....	Élément.....	Elemento
60	060-0062	5	Washer, copper.....	Rondelle.....	Arandela
			1.62" O.D. x 1.368" I.D.		
61	043-0098	2	Intake valve assy, low pressure ...	Ensemble de la soupape .....	Conjunto de válvula
			includes items 61a-61f	d'admission	de admisión
61a	-----	1	Nut, self-locking, hex jam.....	Écrou .....	Tuerca
61b	-----	1	Seat, valve .....	Siège .....	Asiento
61c	-----	1	Plate, valve .....	Plaque.....	Placa
61d	-----	1	Spring, valve .....	Ressort .....	Resorte
61e	-----	1	Guide, valve .....	Guide .....	Guía
61f	-----	1	Bolt, M6 x 20 mm lg .....	Boulon.....	Perno
62	043-0099	1	Intake valve assy, high pressure..	Ensemble de la soupape .....	Conjunto de válvula
			includes items 62a-62f	d'admission	de admisión
62a	-----	1	Nut, self-locking, hex jam.....	Écrou .....	Tuerca
62b	-----	1	Seat, valve .....	Siège .....	Asiento
62c	-----	1	Plate, valve .....	Plaque.....	Place
62d	-----	1	Spring, valve .....	Ressort .....	Resorte
62e	-----	1	Guide, valve .....	Guide .....	Guía
62f	-----	1	Bolt, M6 x 20 mm lg .....	Boulon.....	Perno
63	043-0100	2	Exhaust valve assy, high & low....	Ensemble de soupape .....	Conjunto de válvula
			includes items 63a-63e	d'échappement	de escape
63a	-----	1	Bolt, M6 x 12 mm lg .....	Boulon.....	Perno
63b	-----	1	Guide, valve .....	Guide .....	Guía
63c	-----	1	Spring, valve .....	Ressort .....	Resorte
63d	-----	1	Plate, valve .....	Plaque.....	Placa
63e	-----	1	Seat, valve .....	Siège .....	Asiento
64	043-0094	3	Spacer, intake valve.....	Entretoise.....	Espaciador
65	043-0095	2	Spacer, exhaust valve.....	Entretoise.....	Espaciador
66	058-0082	2	Retainer, valve, low pressure.....	Retenue .....	Retenedor
67	058-0083		Retainer, valve.....	Retenue .....	Retenedor
			low pressure exhaust or		
			high pressure intake and exhaust		
68	046-0174	3	Gasket, valve cover .....	Joint .....	Empaquetadura
69	077-0073	3	Cover, valve .....	Couvercle.....	Tapa
70	059-0157	4	Bolt, M8 x 90 mm lg .....	Boulon.....	Perno
71			N/A .....	N/A .....	N/A
72	082-0012	1	Intercooler .....	Refroidisseur intermédiaire .....	Enfriador intermedio
73	136-0046	1	Valve, pressure relief, 75 PSI .....	Soupape .....	Válvula
74	063-0006	1	Bushing, reducer.....	Bague .....	Buje
75	046-0166	1	Gasket, cylinder head.....	Joint .....	Empaquetadura

DATE 5/24/00

ORIGINAL

# MODEL 040-0211

PARTS LIST \_\_\_\_\_ LISTE DE PIÈCES \_\_\_\_\_ LISTA DE LAS PIEZAS \_\_\_\_\_

**PUMP SC23**

Item Art Art	Part No Nº / P Núm / P	Qty Qté Cant	Description	Description	Descripción
76	050-0030	1	Cylinder .....	Cylindre .....	Cilindro
77	046-0167	1	Gasket, cylinder/crankcase.....	Joint .....	Empaquetadura
78	046-0178	1	Gasket, sight glass .....	Joint .....	Empaquetadura
79	032-0031	1	Flange, w/sight glass .....	Bride .....	Brida
80	059-0153	2	Bolt, M8 x 30 mm lg .....	Boulon.....	Perno

## AVAILABLE SERVICE KITS

Part No	Description	Description	Descripción
046-0183	Gaskets, complete set includes items 2, 14, 19, 23, 45 50, 57, 68, 75, 77, 78, washers 21, 45 and 60	Joints, jeu complet includ les éléments 2, 14, 19, 23, 45, 50, 57, 68, 75, 77, 78, rondelles 21, 45 et 60	Juntas, conjunto completo incluye los artículos 2, 14, 19, 23, 45, 50, 57, 68, 75, 77, 78, arandelas 21, 45 y 60
046-0184	Gaskets, valve set includes items 68, five washers item 60 and three washers item 21	Joints, jeu de soupape includ les éléments 68, cinq rondelles, les élément 60 et tres rondelles, les élément 21	Juntas, conjunto des válvula incluye los artículos 68, cinco arandelas, los artículo 60 y tres arandelas, los artículo 21
070-0020	Centrifugal unloader assy includes items 4-8	Ensemble de régulateur de pression centrifuge includ les éléments 4 - 8	Conjunto de descargador centrifugo incluye los artículos 4 - 8
165-0064	Overhaul kit includes items 046-0183, 33, 34, 38,42,61,62, and 63	Jeu de pièces de remise en état includ les éléments, 33, 34, 38 et 42	Juego de reparación general incluye los artículos 33, 34,38 y 42

**\*\*Items must be purchased separately when ordering the pump assembly, if needed.**

**\*\*Des elements doivent etre achetes seperately en commandant le pompe si necessaire.**

**\*\*Los items deben comprados seperately al pedir el ensamblaje de la bomba si estan necesitados.**