

# Air Compressor Parts Manual

200-1936

Rev. D

## 5 H.P. ELECTRIC STATIONARY TWO STAGE INDUSTRIAL B4900A PUMP

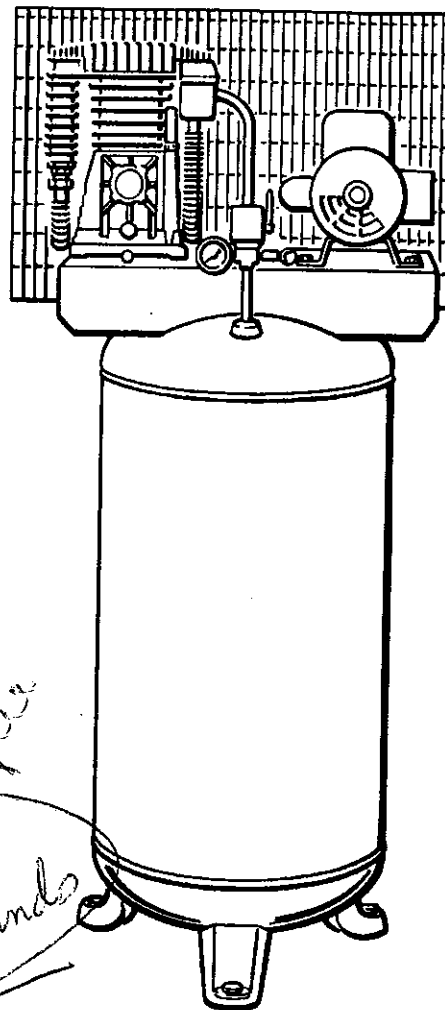

1/4 turn valve  
optional

### MODEL

**51-A21** see pages 2, 3, 6 & 7

**51-AT21** see pages 4, 5, 6 & 7

*13.75  
- 19.17  
Ft Pounds*

### SPECIFICATION CHART

MODEL NO.	H.P.	AIR RECEIVER TANK CAPACITY GALLONS	VOLTAGE/ AMPS/ PHASE	SCFM Displ @ 100 PSI	SCFM Displ @ 175 PSI	APPROX. KICK-IN PRESSURE	APPROX. KICK-OUT PRESSURE
51-A21-60V	5	Vertical 60	230/22/1	16	15	145	175
51-A21-80V	5	Vertical 80	230/22/1	16	15	145	175
51-AT21-80V	5	Vertical 80	230/22/1	16	15	145	175

In the event you should have a question, or a concern, with the air compressor, **DO NOT return** it to the store where you purchased it. Most problems and concerns can be taken care of on the telephone!

Simply call (800) 544-5145 (Toll Free) and discuss the concern with our trained Customer Service Department.

Should you not be able to reach us at the above numbers, please check the Service Center Listing included with your instruction manual and call the Service Center nearest you for assistance.

**CAUTION:** Read the operator's manual carefully before attempting to operate or service this unit! FAILURE TO COMPLY WITH INSTRUCTIONS COULD RESULT IN: VOIDING OF YOUR WARRANTY, PERSONAL INJURY AND / OR PROPERTY DAMAGE! This Air Compressor is precision built from the finest materials and with proper care and maintenance will perform efficiently.

# PARTS DRAWING

NOTE: Item 6 must be assembled or disassembled with pump items 32, 33 and 34 from page 4.

1/2-14 NPTF EXHAUST PORT

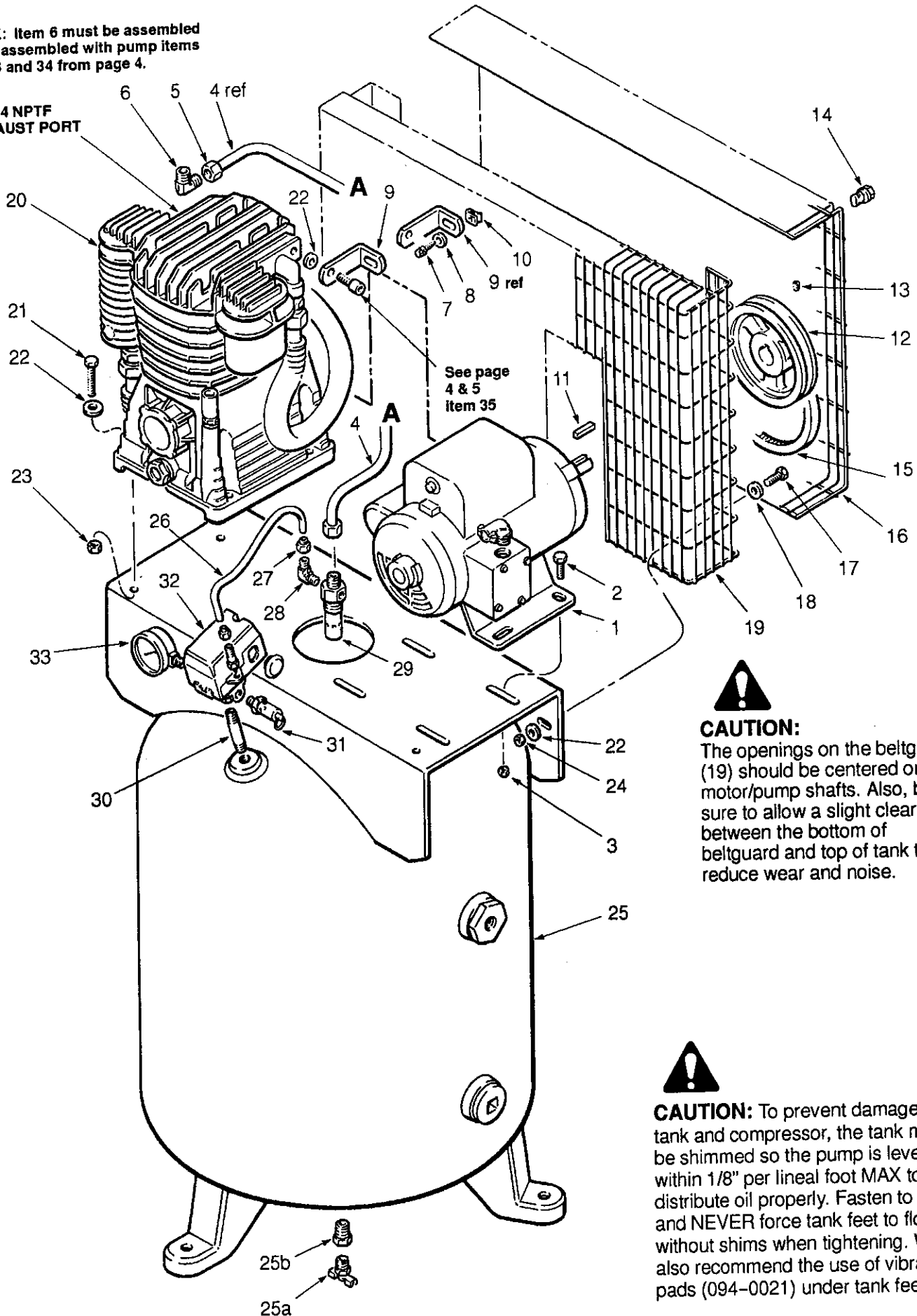

**CAUTION:**

The openings on the beltguard (19) should be centered on motor/pump shafts. Also, be sure to allow a slight clearance between the bottom of beltguard and top of tank to reduce wear and noise.



**CAUTION:**

To prevent damage to tank and compressor, the tank must be shimmed so the pump is level within 1/8" per lineal foot MAX to distribute oil properly. Fasten to floor and NEVER force tank feet to floor without shims when tightening. We also recommend the use of vibration pads (094-0021) under tank feet.

# PARTS LIST & DRAWING

**MODEL 51-A21-60V** includes items 1-33  
on pages 2 & 3, items 38-41 on pages 6 & 7  
**5 H.P. STATIONARY 60 gal with B4900A pump**

**MODEL 51-A21-80V** includes items 1-33  
on pages 2 & 3, items 38-41 on pages 6 & 7  
**5 H.P. STATIONARY 80 gal with B4900A pump**

ITEM	PART NO	DESCRIPTION	QTY
1	160-0145	MOTOR, 5 H.P.	1
2	059-1007	SCREW,	4
3	058-0009	NUT,	4
4	145-0203	TUBE, transfer, 60 gal model or	
	145-0176	TUBE, transfer, 80 gal model	1
5	058-0016	COMP. NUT & SLEEVE	2
6	064-0002	ELBOW, 90°	1
7	061-0005	SCREW, #10 x 3/4" lg	1
8	060-0029	WASHER,	1
9	114-0224	BRACKET, 60 gal model or	
	114-0214	BRACKET, 80 gal model	1
10	103-0061	CLIP	1
11	146-0016	KEY, 3/16" x 1" lg	1
12	006-0086	PULLEY	1
13	061-0009	SETSCREW,	1
14	103-0073	FASTENER, 1/4 turn top of beltguard	2
		back of beltguard	4
15	007-0001	V-BELT	1
16	115-0055	BELT GUARD, back, 60 gal or	
	115-0053	BELT GUARD, back, 80 gal	1
17	059-0045	SCREW, 1/4" x 3/4" lg outside	2
	or		
	059-0215	SCREW, 1/4" x 1/2" lg middle	1
18	060-0093	WASHER, 1/4"	5

ITEM	PART NO	DESCRIPTION	QTY
19	116-0089	BELTGUARD, inner, 60 gal or	
	116-0085	BELTGUARD, inner, 80 gal	1
20	040-0176	PUMP ASSEMBLY, B4900A See pages 4 & 5 for parts	1
21	059-0015	BOLT, 5/16" x 2" lg	4
22	060-0005	WASHER, 3/8"	9
23	058-0005	NUT, 5/16"	4
24	058-0032	NUT, 1/4"	2
25	021-0154	TANK ASSEMBLY, 60 gal includes item 25a & 25b or	
	021-0155	TANK ASSEMBLY, 80 gal includes item 25a & 25b	1
25a	072-0001	.PETCOCK	1
25b	063-0001	.BUSHING	1
26	145-0223	TUBE, bleeder, 14" lg	1
27	058-0017	COMP. NUT & SLEEVE	2
28	064-0003	ELBOW, 90° 1/8" NPT x 1/4" tube	2
29	031-0041	VALVE, check	1
30	065-0005	NIPPLE, 1/4" NPT x 2 1/2" lg	1
31	136-0007	VALVE, pressure relief	1
32	034-0092	SWITCH, pressure includes 32a	1
32a	136-0013	.VALVE, unloader, includes valve, nut, star washer & comp. nut	1
33	032-0025	GAUGE	1

## UNLOADER VALVE DETAIL

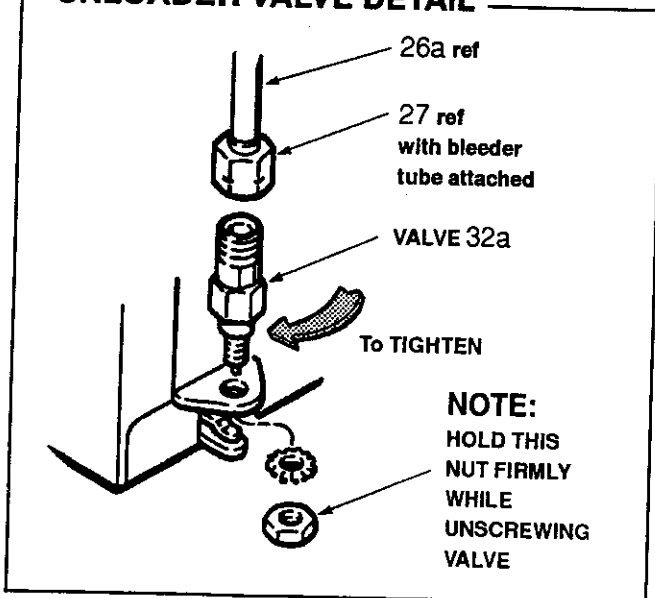

# PARTS DRAWING

**NOTE:** Item 6 must be assembled or disassembled with pump items 32, 33 and 34 from page 4.

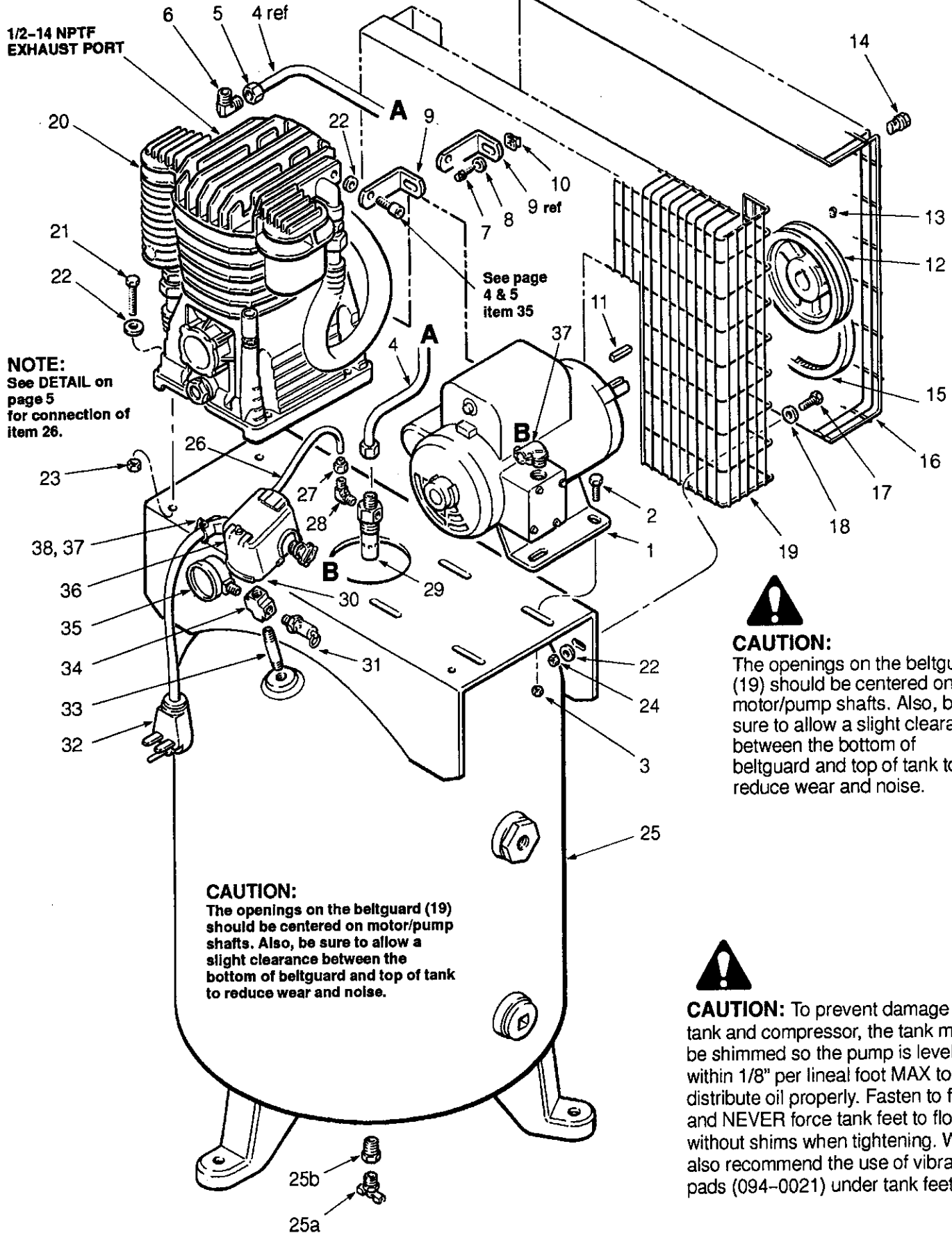

# PARTS LIST & DRAWING

**MODEL 51-AT21-80V** includes items 1-38  
 on pages 4 & 5, items 38-41 on pages 6 & 7  
**5 H.P. STATIONARY 80 gal with B4900A pump**

ITEM	PART NO	DESCRIPTION	QTY	ITEM	PART NO	DESCRIPTION	QTY
1	160-0145	MOTOR, 5 H.P.	1	21	059-0015	BOLT, 5/16" x 2" lg	4
2	059-0060	SCREW,	4	22	060-0023	WASHER, 3/8"	9
3	058-0006	NUT,	4	23	058-0005	NUT, 5/16"	4
4	145-0203	TUBE, transfer, 60 gal model		24	058-0032	NUT, 1/4"	2
	145-0176	TUBE, transfer, 80 gal model	1	25	021-0154	TANK ASSEMBLY, 60 gal	
5	058-0016	COMP. NUT & SLEEVE	2			includes item 25a & 25b	
6	064-0002	ELBOW, 90°	1		or		
7	061-0005	SCREW, #10 x 3/4" lg	1	021-0155	TANK ASSEMBLY, 80 gal		
8	060-0029	WASHER,	1			includes item 25a & 25b	1
9	114-0224	BRACKET, 60 gal model	1	25a	072-0001	.PETCOCK	1
	114-0214	BRACKET, 80 gal model	1	25b	063-0001	.BUSHING	1
10	103-0061	CLIP	1	26	145-0223	TUBE, bleeder	1
11	146-0016	KEY, 3/16" x 1" lg	1	27	058-0017	COMP. NUT & SLEEVE	2
12	006-0086	PULLEY	1	28	064-0003	ELBOW, 90°	
13	061-0009	SETSCREW,	1			1/8" NPT x 1/4" tube	2
14	103-0073	FASTENER, 1/4 turn	1	29	031-0041	VALVE, check	1
		top of beltguard	2	30	065-0031	NIPPLE, 1/4" NPT x 7/8" lg	1
		back of beltguard	4	31	136-0007	VALVE, pressure relief	1
15	007-0001	V-BELT	1	32	031-0147	CORD, power	1
16	115-0055	BELT GUARD, back, 60 gal	1	33	065-0005	NIPPLE, 1/4" NPT x 2.5" lg	1
	115-0053	BELT GUARD, back, 80 gal	1	34	028-0005	CROSS	1
17	059-0045	SCREW, 1/4" x 3/4" lg	2	35	032-0025	GAUGE	1
	059-0215	SCREW, 1/4" x 1/2" lg	1	36	034-0086	SWITCH, pressure	
18	060-0093	WASHER, 1/4"	5			includes 36a	1
19	116-0089	BELTGUARD, inner, 60 gal	1	36a	136-0040	.VALVE, unloader, includes	1
	116-0085	BELTGUARD, inner, 80 gal	1			valve, nut, star washer & comp. nut	2
20	040-0176	PUMP ASSEMBLY, B4900A	1	37	071-0003	STRAIN RELIEF, 90°	1
		See pages 6 & 7 for parts	1	38	071-0002	STRAIN RELIEF, straight	1
				39	026-0184	CORD, interconnect B-B	1

## UNLOADER VALVE DETAIL

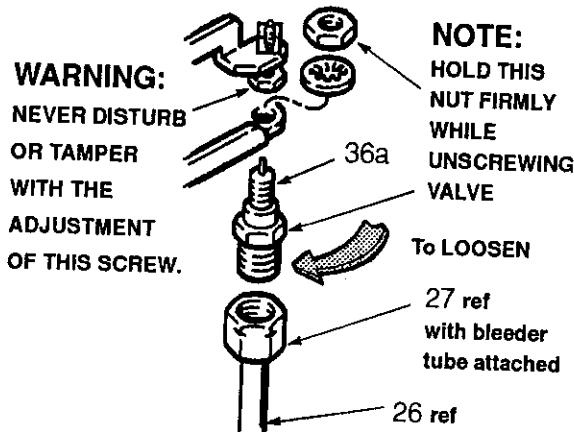

*B24-0108*

# PARTS DRAWING

## PUMP B4900A

NOTE: Item 6 from page 2 must be assembled or disassembled with item 33.

### PUMP SPECIFICATIONS

WEIGHT - 29 LBS  
 OIL GRADE - SAE 40  
 CAPACITY - 44 OZ.  
 MAX RPM - 1450

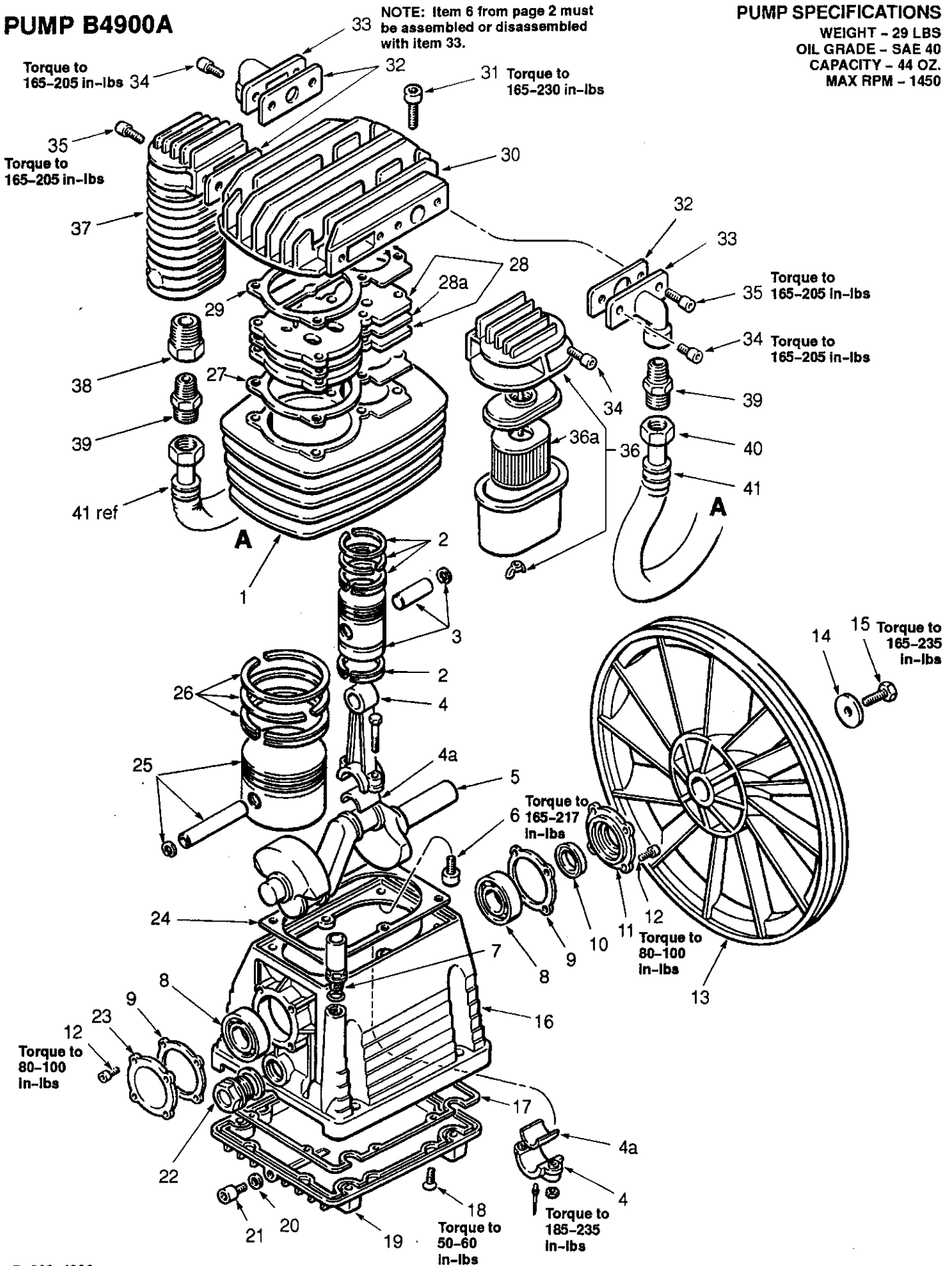

# PARTS LIST

**PUMP B4900A 040-0176** includes items 1-37

ITEM	PART NO	DESCRIPTION	QTY	ITEM	PART NO	DESCRIPTION	QTY
1	050-0036	CYLINDER	1	28	043-0140	VALVE PLATE ASSEMBLY	
2	054-0146	RING SET, high press.	1			includes item 28a	1
3	048-0063	PISTON ASSEMBLY, high press.	1	28a	046-0210	GASKET, valve plate, middle	1
4	047-0064	CONNECTING ROD ASSEMBLY		29	046-0215	GASKET, head	1
		includes item 4a, bolt, nut & splash rod	2	30	042-0072	HEAD, cylinder	1
4a	051-0066	INSERTS, bearing	2 pr	31	059-0194	BOLT, M8 x 45 mm	1
5	053-0056	CRANKSHAFT	1	32	046-0219	GASKET, intercooler	3
6	059-0030	BOLT, M8 x 20 mm	6	33	082-0019	ADAPTER, outlet	2
7	056-0029	BREATHER, oil filler w/gasket	1	34	059-0035	BOLT, M8 x 20 mm	5
8	051-0067	BEARING, crankshaft	2	35	059-0192	BOLT, M8 x 25 mm	3
9	046-0216	GASKET, bearing cover	2	36	019-0149	AIR FILTER ASSEMBLY	
10	046-0217	SEAL, oil	1			includes item 36a	1
11	077-0097	COVER, bearing	1	36a	019-0154	ELEMENT, filter	1
12	059-0195	BOLT, M6 x 14 mm	8	37	082-0020	INTERCOOLER	1
13	044-0052	FLYWHEEL, 14.5" diameter	1	<b>38-41 ARE NOT INCLUDED with PUMP ASSEMBLY 040-0176</b>			
14	060-0079	WASHER, flywheel	1	38	063-0039	BUSHING	1
15	059-0191	BOLT, M8 x 25 mm	1	39	068-0036	CONNECTOR, male	2
16	049-0036	CRANKCASE	1	40	058-0012	NUT, compression	2
17	046-0212	GASKET, crankcase base	1	41	145-0177	TUBE, intercooler	1
18	061-0044	BOLT, #10 x 5/8"	8	<b>AVAILABLE SERVICE KITS</b>			
19	077-0095	BASE, crankcase	1	<b>PART NO</b>	<b>DESCRIPTION</b>		
20	060-0080	WASHER, drain bolt	1	046-0211	GASKETS, complete set		
21	059-0196	BOLT, M8 x 16 mm	1		includes items 9, 17, 24, 27, 28a, 29 & 32		
22	032-0044	SIGHT GLASS, w/gasket	1	165-0097	OVERHAUL KIT,		
23	077-0096	COVER, bearing	1		includes items 2, 26, 28 & 36a		
24	046-0213	GASKET, crankcase	1				
25	048-0064	PISTON ASSEMBLY, low press.	1				
26	054-0147	RING SET, low press.	1				
27	046-0214	GASKET, cylinder	1				